

▶ SKY-ES SERIES SAFETY COUPLING

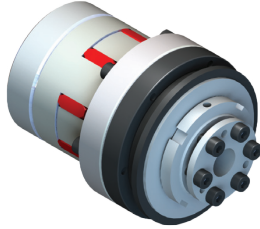

Major Features

- Elastomer safety coupling with self-centering conical hub and radial clamping hubs.
- Upon disengagement, coupling will re-engage automatically at only one point per revolution and retain the drive's reference point.
- Star-shaped elastomer element with involute tooth profile and high shore hardness ensures zero backlash over life of product.
- Electrically insulating and dampens oscillation resonance.

Material

- Steel hubs; elastomer spider; steel safety element

Size SKY-ES	Disengagement Torque Range		Moment of Inertia	Torsion Resistance	Max. Lateral Misalignment	Mass	Screw Size	Torque to Tighten Screws		Outer Diameter	Length	Bore Range øD1*		Bore Range øD2**	
	Nm (lb-in)	Nm (lb-in)	10 ⁻³ kgm ² (lb-in ²)	Nm/arcmin (lb-ft/Deg)	mm (inch)	kg (lbs)	*/**	Nm* (lb-in)	Nm** (lb-in)	mm (inch)	mm (inch)	mm (inch)	mm (inch)	mm (inch)	mm (inch)
SKY-ES-6	2	6	0.13	0.24	0.1	0.5	M4/M3	4	2	52.5	83	9	19	5	11.5
	(18)	(53)	(0.44)	(11)	(0.004)	(1.10)		(35)	(18)	(2.067)	(3.268)	(0.354)	(0.748)	(0.197)	(0.453)
SKY-ES-12	6	12	0.13	0.24	0.1	0.5	M4/M3	4	2	52.5	83	9	19	5	11.5
	(53)	(106)	(0.44)	(11)	(0.004)	(1.10)		(35)	(18)	(2.067)	(3.268)	(0.354)	(0.748)	(0.197)	(0.453)
SKY-ES-15	8	15	0.5	0.6	0.1	1	M5/M4	8	4	69	100	12	26	9	17
	(71)	(133)	(1.71)	(27)	(0.004)	(2.20)		(71)	(35)	(2.717)	(3.937)	(0.472)	(1.024)	(0.354)	(0.669)
SKY-ES-30	13	30	0.5	0.6	0.1	1	M5/M4	8	4	69	100	12	26	9	17
	(115)	(266)	(1.71)	(27)	(0.004)	(2.20)		(71)	(35)	(2.717)	(3.937)	(0.472)	(1.024)	(0.354)	(0.669)
SKY-ES-45	22	45	0.5	0.6	0.1	1	M5/M4	8	4	69	100	12	26	10	17
	(195)	(398)	(1.71)	(27)	(0.004)	(2.20)		(71)	(35)	(2.717)	(3.937)	(0.472)	(1.024)	(0.394)	(0.669)
SKY-ES-60	25	60	1.4	1.05	0.1	1.9	M5/M6	8	18	88	115.5	12	36	12	24
	(221)	(531)	(4.78)	(46)	(0.004)	(4.19)		(71)	(159)	(3.465)	(4.547)	(0.472)	(1.417)	(0.472)	(0.945)
SKY-ES-100	40	100	1.4	1.05	0.1	1.9	M5/M6	8	18	88	115.5	12	36	12	24
	(354)	(885)	(4.78)	(46)	(0.004)	(4.19)		(71)	(159)	(3.465)	(4.547)	(0.472)	(1.417)	(0.472)	(0.945)
SKY-ES-150	60	150	1.4	1.05	0.1	1.9	M5/M6	8	18	88	115.5	14	36	14	24
	(531)	(1328)	(4.78)	(46)	(0.004)	(4.19)		(71)	(159)	(3.465)	(4.547)	(0.551)	(1.417)	(0.551)	(0.945)
SKY-ES-230	80	230	5.5	2	0.12	4.3	M8/M6	35	18	115	145.5	19	40	18	35
	(708)	(2036)	(18.79)	(89)	(0.005)	(9.48)		(310)	(159)	(4.528)	(5.728)	(0.748)	(1.575)	(0.709)	(1.378)
SKY-ES-330	130	330	5.5	2	0.12	4.3	M8/M6	35	18	115	145.5	19	40	22	35
	(1151)	(2921)	(18.79)	(89)	(0.005)	(9.48)		(310)	(159)	(4.528)	(5.728)	(0.748)	(1.575)	(0.866)	(1.378)
SKY-ES-500	200	500	18.5	8	0.15	8.8	M12/M8	115	35	137	187	25	60	28	44
	(1770)	(4425)	(63.22)	(354)	(0.006)	(19.40)		(1018)	(310)	(5.394)	(7.362)	(0.984)	(2.362)	(1.102)	(1.732)
SKY-ES-800	350	800	18.5	8	0.15	8.8	M12/M8	115	35	137	187	28	60	30	44
	(3098)	(7081)	(63.22)	(354)	(0.006)	(19.40)		(1018)	(310)	(5.394)	(7.362)	(1.102)	(2.362)	(1.181)	(1.732)
SKY-ES-1000	500	1000	57	12	0.1	16	M12/M12	115	115	181	218	48	60	40	70
	(4425)	(8851)	(194.78)	(531)	(0.004)	(35.27)		(1018)	(1018)	(7.126)	(8.583)	(1.890)	(2.362)	(1.575)	(2.756)

Coupling must be selected so nominal torque is higher than highest operational torque of the application (i.e., during acceleration).
Bore diameters smaller than the minimum are possible but reliable transmission of nominal torque cannot be guaranteed.

*Bellows side of coupling

**Safety element

Sold & Serviced By:
ELECTROMATE

Toll Free Phone (877) SERV098
Toll Free Fax (877) SERV099
www.electromate.com
sales@electromate.com