

ELIMINATOR SS™

Sold & Serviced By:
ELECTROMATE
 Toll Free Phone (877) SERV098
 Toll Free Fax (877) SERV099
 www.electromate.com
 sales@electromate.com

Super Speed Ball Screw Linear Actuators



- Velocity to 65 in/sec
- Thrusts to 2,000 LBF
- Heavy Wall Steel Construction
- Highest (B10) Life Rating
- Piston with Rugged Anti-Rotation
- Adjustable Limit Switch Positions
- Sealed Chamber Design

ELIMINATOR SS™ Capabilities

Model Number	Thrust Load Rated	Thrust Load Max.	Linear Velocity Max.	Travel Length ⁽¹⁾ Max.	Frame Size	Lead ⁽²⁾	Ball Screw Diameter	Ball Screw Speed Max.	Torque @ Ball Screw Max.	Dynamic Capacity per million revs (lb _f)	Dynamic Capacity per million inches (lb _f)	Motor/ ⁽³⁾ Gearhead Frame Supported Max. (in)	Unit Weight "U" Motor Mount (lb)	Unit Weight "L" Motor Mount (lb)
	(lb _f)	(lb _f)	(in/s)	(in)	(in)	(in)	(in)	(RPM)	(in-lb)	(lb _f)	(lb _f)	(in)	(lb)	(lb)
SS454-12	2,000	4,000	65	12	4.5	1.875	1.50	2,080	663	5,960	7,350	7	100	75
SS454-18	2,000	4,000	65	18	4.5	1.875	1.50	2,080	663	5,960	7,350	7	115	90
SS454-24	2,000	4,000	65	24	4.5	1.875	1.50	2,080	663	5,960	7,350	7	130	105
SS454-30	2,000	4,000	65	30	4.5	1.875	1.50	2,080	663	5,960	7,350	7	145	120
SS454-36	2,000	4,000	65	36	4.5	1.875	1.50	2,080	663	5,960	7,350	7	160	135
SS454-42	2,000	4,000	65	42	4.5	1.875	1.50	2,080	663	5,960	7,350	7	175	150
SS454-48	2,000	4,000	65	48	4.5	1.875	1.50	2,080	663	5,960	7,350	7	190	165

⁽¹⁾ Intermediate lengths are available; Longer lengths possible.

⁽²⁾ Standard lead accuracy is 0.005 in/ft

Standard backlash is 0.005 in maximum; Optional zero backlash is also available.

⁽³⁾ Motor adapter plates are available for larger motor frames.

Graph: Life Vs. Load

Life vs Load

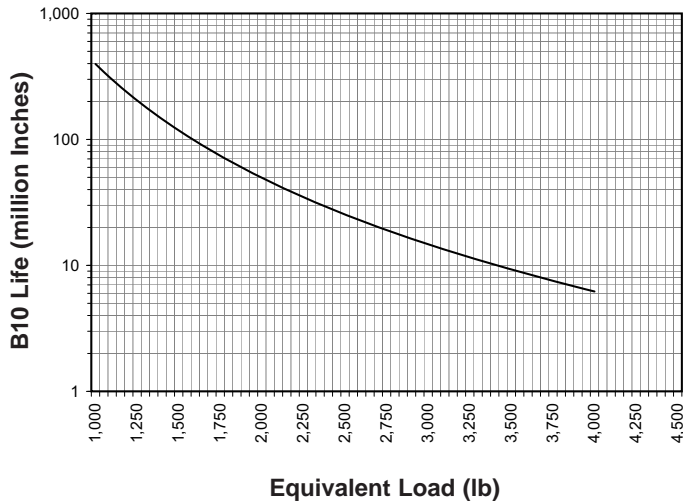

Graph 2: Torque Vs. Thrust at Ball Screw

Torque vs Thrust

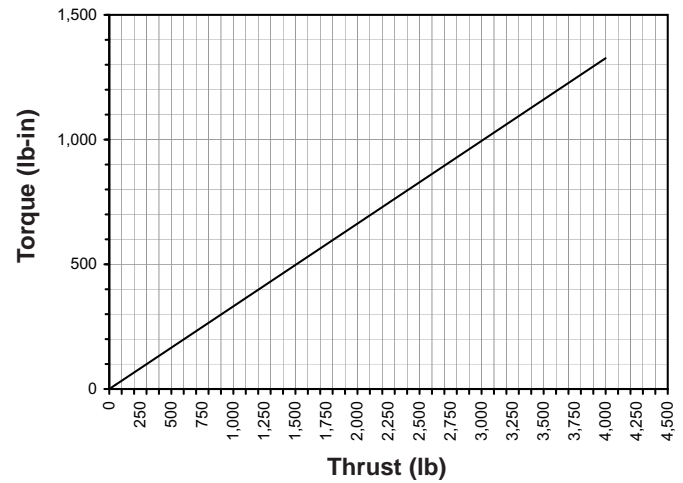

This chart is for a 1:1 gearbelt or in-line arrangement. For 2:1, motor torque will be reduced by 50%.

U-Parallel Offset Motor Dimensions

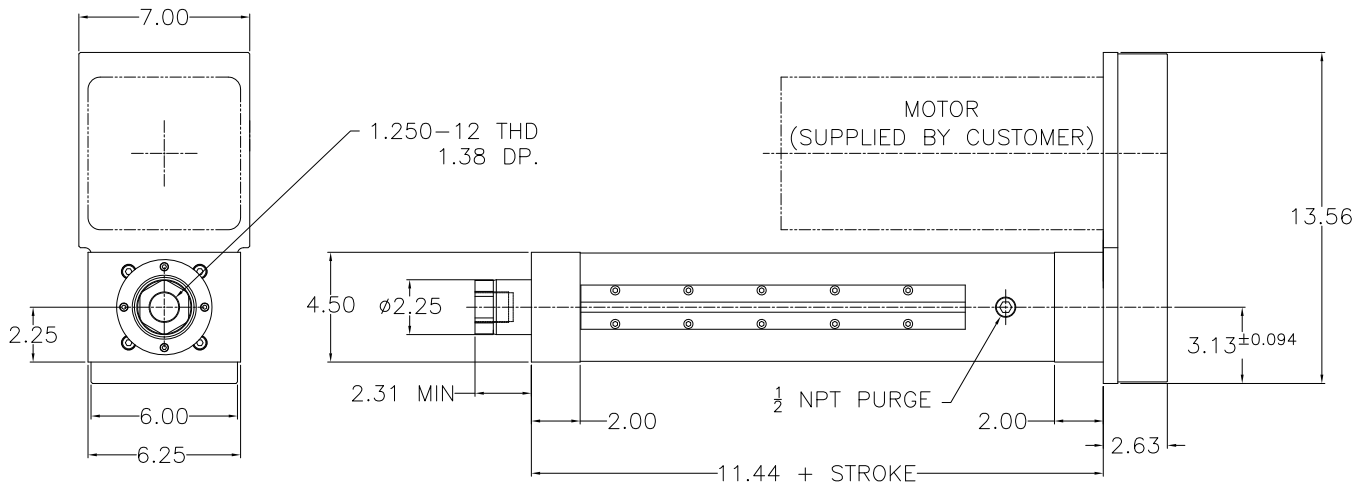

L-Inline Motor Dimensions

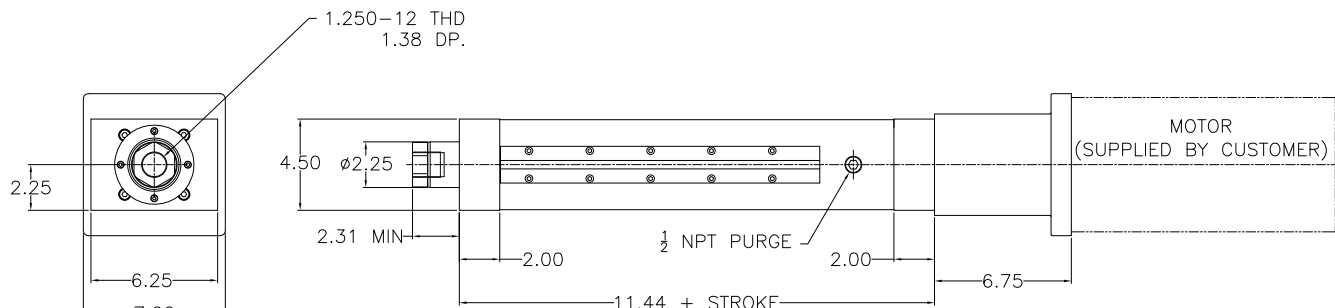

Bottom Mount Dimensions

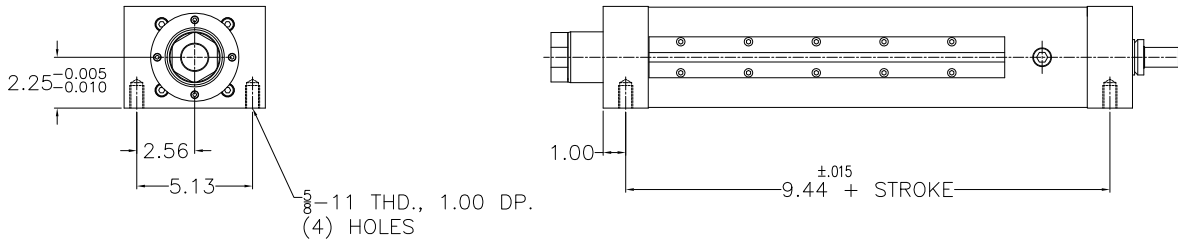

Front Flange Dimensions

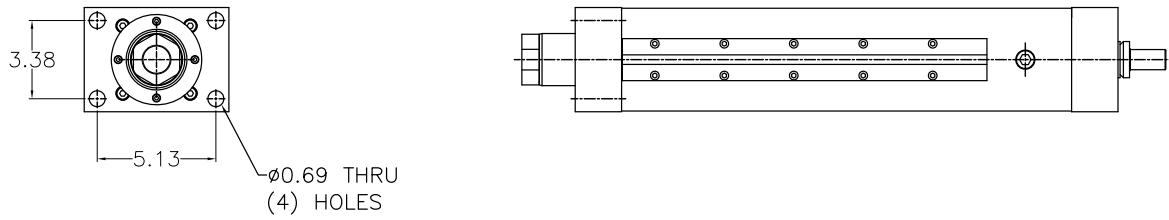

Foot Mount Dimensions

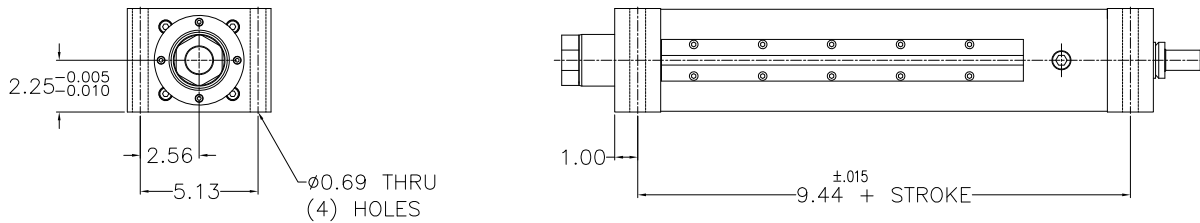

Trunnion Mount Dimensions

